

Nursing Education Building University of Pennsylvania

Location: Philadelphia, Pennsylvania
Client: University of Pennsylvania
Size: 15,000sf
Cost: \$400,000
Status: Completed August 2005

Viridian Landscape Studio transformed a forbidding and unfriendly, walled and paved 1970s plaza into an urban garden entry court. Working closely with the total building renovation architects, VLS carefully designed an inclusive building entry sequence. Both the entry stairs and ADA access path weave through the garden and deliver users to the front door and the outdoor café.

To ensure long-term garden success, we brought soil scientist Tim Craul to the project. Mr. Craul developed a special soil mix in which to grow the new garden. Gardens soil weights were coordinated with the structural engineer as the mix was placed atop the existing underground parking structure. The soil supports a lush matrix of trees, shrubs and groundcovers modeled on Pennsylvania's dry northern slopes, creating a woodland escape in the city. The project serves as the first intervention in transforming the north service drive into a pedestrian friendly campus amenity.

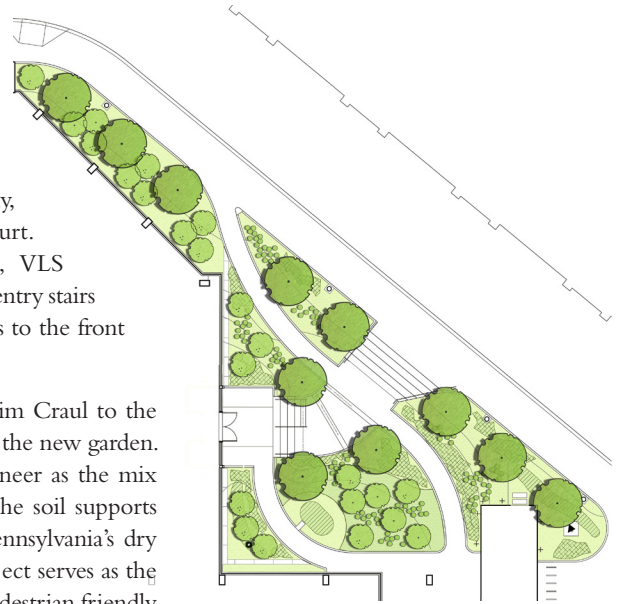

Prior to renovation, the walled court was forbidding and unfriendly. With the glass-enclosed lobby and landscaped courtyard, the new entrance to the Nursing Education Building is a welcoming garden oasis.

