

## Bucknell University: Roberts Hall Quadrangle

*Location:* Lewisburg, Pennsylvania

*Client:* Bucknell University

*Size:* 3.25 acres

*Cost:* \$900,000

*Status:* Construction Start Date 2016

In the Spring of 2016, Bucknell University approached Viridian and asked if they could reimagine the Roberts Hall Quadrangle in time for a Fall 2016 construction. Viridian not only developed a new design, but also delivered full construction documents on time and on budget.

The historic quadrangle was cluttered with old yew hedges, limited site furniture, and had not been renovated in years. Viridian collaborated with the architect renovating Robert's Hall and the university building committee. They presented a variety of university quadrangle types and sizes across the world, and lead the team in lively discussions of plaza types, materials and the ways in which people use outdoor spaces. These discussions lead Viridian to develop a European style plaza with moveable furniture sitting on a stone dust field. This simple approach unifies the quad while preserving existing trees. Hammocks and string lights will be introduced seasonally. The quadrangle renovation gives residence hall occupants and the users of the newly renovated Carnegie building a place for social interchange amidst the huge tree trunks, underneath the magnificent, old, leafy canopy.

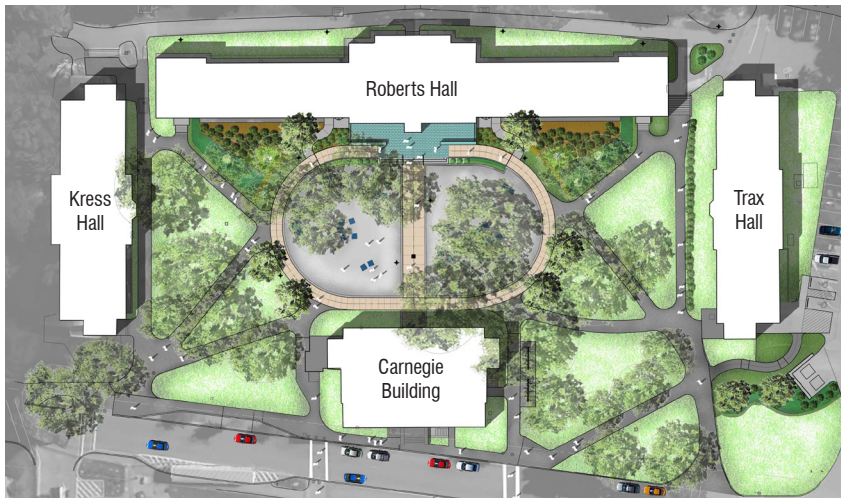

*Plan View Rendering*



*Concept Rendering*



*Existing condition of entry*



*Concept Rendering*



*Existing condition photos*

